

ORIGINAL 1

CUMBRIA COUNTY COUNCIL

THE HIGHWAYS ACT 1980

THE CUMBRIA COUNTY COUNCIL

**(A689 (CARLISLE SOUTHERN LINK ROAD)
CLASSIFIED ROAD) (SIDE ROADS AND OTHER
WORKS)**

ORDER 2020

CONTENTS

SIDE ROADS ORDER INCLUDING THE SCHEDULES

PLAN FOLIO

KEY PLAN

ORDER SITE PLANS 1 TO 6

CUMBRIA COUNTY COUNCIL

THE HIGHWAYS ACT 1980

THE CUMBRIA COUNTY COUNCIL

**(A689 (CARLISLE SOUTHERN LINK ROAD)
CLASSIFIED ROAD) (SIDE ROADS AND OTHER
WORKS)**

ORDER 2020

CONTENTS

SIDE ROADS ORDER INCLUDING THE SCHEDULES

PLAN FOLIO

KEY PLAN

ORDER SITE PLANS 1 TO 6

HIGHWAYS ACT 1980

CUMBRIA COUNTY COUNCIL

THE CUMBRIA COUNTY COUNCIL (A689 (CARLISLE SOUTHERN LINK ROAD) CLASSIFIED ROAD) (SIDE ROADS AND OTHER WORKS) ORDER 2020

Cumbria County Council make this Order in exercise of their powers under sections 6, 14 and 125 of the Highways Act 1980 and all other powers enabling them in that behalf:-

1. (1) The Council are authorised in relation to the classified road at Carlisle in the County of Cumbria to:
 - (a) improve the lengths of highway named in the Schedules and shown on the corresponding Site Plan by cross hatching;
 - (b) stop up each length of highway described in the Schedules and shown on the corresponding Site Plan by zebra hatching;
 - (c) construct a new highway along each route whose centre line is shown on a Site Plan by an unbroken black line surrounded by stipple;
 - (d) stop up each private means of access to premises described in the Schedules and shown on the corresponding Site Plan by a solid black band; and
 - (e) provide new means of access to premises along each route or at each location shown on a Site Plan by thin diagonal hatching.
 - (2) Where a new highway is to be constructed wholly or partly along the same route as a new access or part of one, that new highway shall be created subject to the private rights over that new access.
 - (3) Each new highway is given a reference letter on a Site Plan, which is also placed in the respective Schedule, and will be a road unless the word "footpath", "bridleway" or "cycle track" appears beneath its reference letter in that Schedule, in which case it will be a footpath, bridleway or cycle track as the case may be. Each new access is given a number on a Site Plan, which is also placed in the respective Schedule.
 - (4) Where a new highway is to be constructed or a new access is to be provided in connection with the stopping up of a length of highway or private means of access described in a Schedule, its reference letter or number (as the case may be) is placed in that Schedule opposite the description of that length.
 - (5) Each Site Plan shows the works indicated in the respective Schedule and has the same number as that Schedule, and the route of the classified road in relation to those works.
2. Where immediately before a length of highway is stopped up in pursuance of this Order there is under, in, on, over, along or across that highway any apparatus of statutory undertakers or any telecommunications code system operator then, subject to section 21 of the Highways Act 1980, those undertakers, or that operator, as the case may be, shall have the same rights as respects that apparatus as they had immediately before the stopping up took place.

3. In this Order:

- (a) distances are measured along the route of the relevant highway or private means of access to premises, as the case may be;
- (b) a reference to a Schedule or Site Plan number is a reference to the Schedule, or to the Site Plan, so numbered;
- (c) "the classified road" - means the highway which the Council propose to construct from the A595/A689 Newby West roundabout south-eastwards for a distance of 8.1km to the M6 Motorway Junction 42, and which is a proposed highway which is a classified road in accordance with section 12 of the Highways Act 1980;
- "the Council" - means Cumbria County Council;
- "improvement" - in relation to a highway includes raising, lowering or otherwise altering that highway, and "improved" shall be construed accordingly;
- "new access" - means a means of access to premises authorised by this Order to be provided;
- "new highway" - means a highway authorised by this Order to be constructed and "new highways" shall be construed accordingly;
- "Schedule" - means a Schedule to this Order, and "Schedules" shall be construed accordingly;
- "Site Plan" - means one of the plans numbered CSLR-CAP-LSI-00-DR-Z-0101 to 0106 contained in the Plan Folio numbered CSLR-CAP-LSI-00-DR-Z-0107 marked "The Cumbria County Council (A689 (Carlisle Southern Link Road) Classified Road) (Side Roads and Other Works) Order 2020", sealed with the Common Seal of the Council and deposited at the offices of the Council at,

Cumbria County Council
Cumbria House
117 Botchergate
Carlisle
Cumbria
CA1 1RD

a duplicate has been deposited in the Offices of the Secretary of State for Transport.

SCHEDULE 1

Site Plan Title - The Cumbria County Council (A689 (Carlisle Southern Link Road) Classified Road) (Side Roads and Other Works) Order 2020 – Site Plan 1 of 6

Drawing Number - CSLR-CAP-LSI-00-DR-Z-0101

Locality - In the Parish of Cummersdale, near Carlisle

Highways to be improved

The Existing A689

The A595 Wigton Road

The U1161 Peter Lane

Highways to be stopped up

Footpath No. FP111008 from the fenceline at its junction with the A595, north-westwards for a distance of 3m.

The U1161 Peter Lane from the A595 Newby West roundabout edge of circulatory carriageway, south-eastwards for a distance of 187m.

--

--

Reference letters of new highways

--

--

A
(Road)
(See Inset 'A' on Site Plan 1)

B
(Cycle Track with a
right of way on foot)
(See Inset 'B' on Site Plan 1)

Private means of access to be stopped up

Access from the A595 Wigton Road to western farmland, at a point 148m south-westwards of the A595 Newby West roundabout edge of circulatory carriageway. (X1) (See Inset 'A' on Site Plan 1)

Access from the A595 Wigton Road to an electricity substation, at a point 30m north-eastwards of the A595 Newby West roundabout edge of circulatory carriageway. (X2)

Access from the A595 Wigton Road to 'Douglas Nursery' and No 23 Wigton Road, at a point 414m south-westwards of the A595 Newby West roundabout edge of circulatory carriageway. (X3) (See Inset 'A' on Site Plan 1)

Access from the A595 Wigton Road to 'Kingrigg Farm', at a point 239m south-westwards of the A595 Newby West roundabout edge of circulatory carriageway. (X4) (See Inset 'A' on Site Plan 1)

Reference letters of new access

1
(See Inset 'A' on Site Plan 1)

2

3
(See Inset 'A' on Site Plan 1)

4
(See Inset 'A' on Site Plan 1)

Access from the A595 Wigton Road to eastern farmland, at a point 174m north-eastwards of the A595 Newby West roundabout edge of circulatory carriageway. (X5a)

5
(See Inset 'B' on Site Plan 1)

Access from the U1161 Peter Lane to northern farmland, at a point 140m south-eastwards of the A595 Newby West roundabout edge of circulatory carriageway. (X5b) (See Inset 'B' on Site Plan 1)

5
(See Inset 'B' on Site Plan 1)

Access from the U1161 Peter Lane to southern farmland, at a point 320m south-eastwards of the A595 Newby West roundabout edge of circulatory carriageway. Existing access route stopped up from a point 39m south-westwards of the south-western boundary of the U1161 south-westwards for a distance of 107m. (X6)

6
(Continues on Site Plan 2 of 6)

SCHEDULE 2

Site Plan Title - The Cumbria County Council (A689 (Carlisle Southern Link Road) Classified Road) (Side Roads and Other Works) Order 2020 – Site Plan 2 of 6

Drawing Number - CSLR-CAP-LSI-00-DR-Z-0102

Locality - In the Parishes of Cummersdale and Dalston, near Carlisle

Highways to be improved

The U1161 Peter Lane

The B5299 Dalston Road

Highways to be stopped up

The B5299 Dalston Road from a point 197m south of its junction with the centreline of the U1161 Peter Lane, southwards for a distance of 113m.

Part of bridleway No. BW111002 (also known as Grace Lane) from the south-eastern boundary of the B5299 Dalston Road, south-eastwards for a distance of 307m.

Footpath No. FP111005 from a point 282m south from the fenceline at its junction with the U1162 Gilbert Road, southwards for a distance of 260m.

Private means of access to be stopped up

Access from the B5299 Dalston Road to western farmland, at a point 437m south of the centreline of its Junction with the U1161 Peter Lane. (X7) (See Inset 'C' on Site Plan 2)

Access from the B5299 Dalston Road to western farmland, at a point 296m south of the centreline of its Junction with the U1161 Peter Lane. (X8a) (See Inset 'C' on Site Plan 2)

Access from the B5299 Dalston Road to western farmland, at a point 199m south of the centreline of its Junction with the U1161 Peter Lane. (X8b) (See Inset 'E' on Site Plan 2)

Access from the B5299 Dalston Road to western farmland, at a point 162m south of the centreline of its Junction with the U1161 Peter Lane. (X9) (See Inset 'E' on Site Plan 2)

Reference letters of new highways

–

C
(Road)
(See Inset 'D' on Site Plan 2)

D & E
(Cycle Track with a (Footpath)
right of way on foot)

Reference letters of new access

7
(See Inset 'C' on Site Plan 2)

8
(See Inset 'C' on Site Plan 2)

8
(See Inset 'C' on Site Plan 2)

9

Access from the B5299 Dalston Road to eastern farmland, at a point 200m south of the centreline of its Junction with the U1161 Peter Lane. (X11) (See Inset 'E' on Site Plan 2)

11a & 11b
(See Inset 'C'
on Site Plan 2)

Access from the B5299 Dalston Road to No's. 42, 43 and 44 Grace Lane and eastern farmland, at a point 10m north of the centreline of its Junction with the U1161 Peter Lane. Existing Grace Lane private access track to be stopped up from the south-eastern boundary of the B5299 Dalston Road, south-eastwards for a distance of 319m. (X12)

12a, 12b, 12c, 12d, 12e,
12f, 12g, 12h and 12i
(See Inset 'D' on Site Plan 2
for 12a to 12f, 12i, and part of 12g)

SCHEDULE 3

Site Plan Title - The Cumbria County Council (A689 (Carlisle Southern Link Road) Classified Road) (Side Roads and Other Works) Order 2020 – Site Plan 3 of 6

Drawing Number - CSLR-CAP-LSI-00-DR-Z-0103

Locality - In the Parishes of Cummersdale, Dalston, and St Cuthbert Without, near Carlisle

Highways to be improved

—

Highways to be stopped up

Reference letters of new highways

Footpath No. FP111004 from its north-eastern end near to the River Caldew, south-westwards for a distance of 264m.
(See Inset 'F' on Site Plan 3)

F & H
(Cycle Track with a right of way on foot) (Footpath)

—

G
(Road)

Footpath No. FP114018 from its north-eastern end at the Dalston Parish boundary, south-westwards for a distance of 68m. (See Inset 'H' on Site Plan 3)

I
(Footpath)

Footpath No. FP111006 from its south-western end at the Cummersdale Parish boundary, north-eastwards for a distance of 120m. (See Inset 'H' on Site Plan 3)

I
(Footpath)

Permissive footpath under proposed Caldew Bridge from a point 110m southwest of the Cummersdale Parish boundary to a point 81m northeast of the Dalston Parish boundary. Total length 191m. (See Inset 'H' on Site Plan 3).

I
(Footpath)

Footpath No. FP129001 from its junction with the centreline of the farm track to Peastree Farm, south-westwards for a distance of 312m.

J
(Footpath)

Footpath No. FP129005 from its junction with footpath No FP129001 south-westwards for a distance of 49m.

J
(Footpath)

Footpath No. FP129004 from a point 125m westwards of its junction with footpath No FP129003, south-westwards for a distance of 238m. (See Inset 'I' on Site Plan 3)

K
(Footpath)

Private means of access to be stopped up

Access from the U1162 Caldew Road to existing private tracks running along the western bank of the River Caldew. Existing private road stopped up from the south-eastern boundary of the U1162 Caldew Road south-eastwards for a distance of 99m. (X13) (See Inset 'F' on Site Plan 3)

--

--

--

Reference letters of new access

13a & 13b
(See Inset 'G' on Site Plan 3)

44
(See Inset 'G' on Site Plan 3)

45

46

SCHEDULE 4

Site Plan Title - The Cumbria County Council (A689 (Carlisle Southern Link Road) Classified Road) (Side Roads and Other Works) Order 2020 – Site Plan 4 of 6

Drawing Number - CSLR-CAP-LSI-00-DR-Z-0104

Locality - In the Parish of St Cuthbert Without, near Carlisle

Highways to be improved

The C1014 (West of Newbiggin Road)

The C1036 Durdar Road

The C1036 (South of Durdar Road)

The U1155

Highways to be stopped up

Footpath No. FP129024 from the fenceline at its junction with the C1014, north-westwards for a distance of 44m. (See Inset 'J' on Site Plan 4)

Footpath No. FP129003 from a point 206m north-west of its junction with the C1014, north-westwards for a distance of 146m.

The C1014 from a point 26m west of its junction with the centreline of the U1155, westwards for a distance of 125m.

The U1155 from a point 9m south of the southern boundary of the C1014 south-westwards for a distance of 112m.

The C1036 Durdar Road from a point 305m south of its junction with the centreline of the C1014 Newbiggin Road, southwards for a distance of 41m.

Private means of access to be stopped up

Access from U1151 to Peastree Farm. Existing track stopped up from the northern boundary of the U1151, northwards for 146m. (X14)

Access from U1151 to Floses Farm. Existing track stopped up from a point 109m to the north of the north-eastern boundary of the U1151, northwards for 43m. (X15)

Access from the C1014 to northern farmland, at a point 347m west of the centreline of the Junction of the U1155. (X16)

Reference letters of new highways

L & O
(Road) (Road)
(See Inset 'L' on Site Plan 4)

M & N & P
(Footpath) (Road) (Cycle Track with a right of way on foot)
(See Inset 'K' on Site Plan 4)

L & N
(Road) (Road)

O
(Road)
(See Inset 'L' on Site Plan 4)

Q
(Road)

Reference letters of new access

14a & 14b

15a & 15b

16a & 16b

--	17
Access from the C1014 to southern farmland, at a point 166m west of the centreline of the Junction of the U1155. (X18)	18
Access from the C1036 Durdar Road to western farmland, at a point 58m north of the centreline of the Junction of Apple Tree Close. (X19)	19
Access from the C1036 Durdar Road to eastern farmland, at a point 76m north of the centreline of the Junction of Apple Tree Close. (X20)	20
Access from the C1036 to western farmland, at a point 484m south of the centreline of the Junction of the C1014 Newbiggin Road. (X21a)	21
Access from the C1036 to western farmland, at a point 254m south of the centreline of the Junction of the C1014 Newbiggin Road. (X21b)	--
Access from the C1036 to western farmland, at a point 243m south of the centreline of the Junction of the C1014 Newbiggin Road. (X22)	--
Access from the C1036 to eastern farmland, at a point 594m south of the centreline of the Junction of the C1014 Newbiggin Road. (X23)	23
Access from the C1036 to eastern farmland, at a point 472m south of the centreline of the Junction of the C1014 Newbiggin Road. (X24)	23
Access from the C1036 to eastern farmland, at a point 243m south of the centreline of the Junction of the C1014 Newbiggin Road. (X25)	25
Access from the C1036 to eastern farmland, at a point 82m south of the centreline of the Junction of the U1156. (X26)	26
Access from the C1036 to eastern farmland, at a point 4m north of the centreline of the Junction of the U1156. (X27)	27

Access from the C1036 to eastern farmland, at a point
164m north of the centreline of the Junction of the
U1156. (X28) 28

Access from the C1036 to eastern farmland, at a point
174m north of the centreline of the Junction of the
U1156. (X29) 29

SCHEDULE 5

Site Plan Title - The Cumbria County Council (A689 (Carlisle Southern Link Road) Classified Road) (Side Roads and Other Works) Order 2020 – Site Plan 5 of 6

Drawing Number - CSLR-CAP-LSI-00-DR-Z-0105

Locality - In the Parish of St Cuthbert Without, near Carlisle

Highways to be improved

The C1014 Newbiggin Road

The C1037 Sclegate Road

The C1037 Burthwaite Road

The C1041

Highways to be stopped up

Reference letters of new highways

The C1014 Newbiggin Road from a point 11m west of its junction with the centreline of the C1037 Sclegate Road, westwards for a distance of 8m.

R
(Road)
(See Inset 'M' on Site Plan 5)

The C1037 Burthwaite Road from a point 271m to the south of the southern boundary of the C1014 Newbiggin Road, southwards for a distance of 106m.

--

The C1041 from a point 90m to the south of the southern boundary of the C1014 Newbiggin Road, southwards for a distance of 106m.

--

Private means of access to be stopped up

Reference letters of new access

Access from the C1037 Burthwaite Road to western farmland, at a point 328m south of the centreline of the C1014 Newbiggin Road. (X30a)

30

Access from the C1037 Burthwaite Road to western farmland, at a point 38m south of the centreline of the C1014 Newbiggin Road. (X30b) (See Inset 'M' on Site Plan 5)

30

Access from the C1037 Burthwaite Road to eastern farmland, at a point 499m south of the centreline of the C1014 Newbiggin Road. (X31) (See Inset 'N' on Site Plan 5)

31
(See Inset 'N' on Site Plan 5)

Access from the C1037 Burthwaite Road to eastern farmland, at a point 308m south of the centreline of the C1014 Newbiggin Road. (X32)

32a & 32b
(See Inset 'M'
on Site Plan 5)

--

33

Access from the C1014 Newbiggin Road to southern farmland. Part of existing access track from a point 251m south of the centreline of the C1014 to a point 282m south of the centreline of the C1014, total length 31m. (X34a)	34
Access from the C1014 Newbiggin Road to Piggery. Part of existing access track from a point 187m south of the centreline of the C1014 to a point 250m south of the centreline of the C1014, total length 63m. (X34b)	34
Access from the C1041 to western farmland, at a point 72m south of the centreline of the C1014 Newbiggin Road. (X35)	35
Access from the C1041 to eastern farmland, at a point 71m south of the centreline of the C1014 Newbiggin Road. (X36)	36

SCHEDULE 6

Site Plan Title - The Cumbria County Council (A689 (Carlisle Southern Link Road) Classified Road) (Side Roads and Other Works) Order 2020 – Site Plan 6 of 6

Drawing Number - CSLR-CAP-LSI-00-DR-Z-0106

Locality - In the Parish of St Cuthbert Without, near Carlisle

Highways to be improved

The C1014 Newbiggin Road

The U1233

The M6 Motorway (Northbound off-slip connector road)

The A6

Highways to be stopped up

The C1014 Newbiggin Road from a point 319m east of its junction with the centreline of the C1041, eastwards for a distance of 362m.

The C1014 Newbiggin Road from the M6 Junction 42 roundabout edge of circulatory carriageway, south-westwards for a distance of 591m.

The U1233 from the northern boundary of the C1014 Newbiggin Road, north-westwards for a distance of 135m.

Footpath No. FP129017 from a point 203m north of the fenceline at its junction with the C1014 Newbiggin Road, northwards for a distance of 96m.

Footpath No. FP129032 from the fenceline at its junction with the C1014 Newbiggin Road, southwards for a distance of 21m.

Permissive footpath to the south of Newbiggin Bridge, from its junction with footpath no. FP129032, southwestwards for a distance of 78m.

Private means of access to be stopped up

Access from the C1014 Newbiggin Road to southern farmland, at a point 298m east of the centreline of the junction to the C1041 Brisco Road. (X37)

Access from the C1014 Newbiggin Road to northern farmland, at a point 385m east of the centreline of the junction to the C1041 Brisco Road. (X38a)

Reference letters of new highways

S
(Road)

S & U
(Road) (Footpath)
(See Inset 'O'
on Site Plan 6)

--

T
(Footpath)
(See Inset 'O' on Site Plan 6)

U
(Footpath)
(See Inset 'O' on Site Plan 6)

U
(Footpath)
(See Inset 'O' on Site Plan 6)

Reference letters of new access

37
(See Inset 'O' on Site Plan 6)

38
(See Inset 'O' on Site Plan 6)

Access from the C1014 Newbiggin Road to northern farmland, at a point 390m east of the centreline of the junction to the C1041 Brisco Road. (X38b)	38 (See Inset 'O' on Site Plan 6)
Access from the U1233 to western farmland, at a point 103m north-west of the centreline of the C1014 Newbiggin Road. (X39a)	39 (See Inset 'O' on Site Plan 6)
Access from the U1233 to eastern farmland, at a point 46m north-west of the centreline of the C1014 Newbiggin Road. (X39b)	39 (See Inset 'O' on Site Plan 6)
Access from the U1233 to 'Station House' at the northern boundary of the U1233. (X40)	Access not required *
Access from the U1233 to 'Newbiggin View' at a point 138m north-west of the centreline of the C1014 Newbiggin Road. Part of existing track to be stopped up from the boundary of the U1233, north-eastwards for a distance of 51m. (X41)	Access not required *
Access from the U1233 to northern farmland at a point 138m north-west of the centreline of the C1014 Newbiggin Road. Part of existing track to be stopped up from the boundary of the U1233, north-eastwards for a distance of 51m. (X41)	41 (See Inset 'O' on Site Plan 6)
Access from the C1014 Newbiggin Road to western farmland, at a point 366m north-east of the centreline of the junction to the U1233. (X42)	42 (See Inset 'O' on Site Plan 6)
Access from the C1014 Newbiggin Road to "Wreay Woods" car park and to an existing track leading to an Environment Agency gauge station and to a track under the m6 motorway leading to farmland east of the M6, at a point 395m north-east of the centreline of the junction to the U1233. (X43a)	43 (See Inset 'O' on Site Plan 6)
Access from the C1014 Newbiggin Road to eastern farmland and to a track leading to a Telecoms mast, at a point 403m east of the centreline of the junction to the U1233. (X43b)	43 (See Inset 'O' on Site Plan 6)

* Premises acquired by agreement and are to be demolished, no new access required.

The COMMON SEAL of the CUMBRIA COUNTY COUNCIL was hereunto affixed
in the presence of:



.....

Authorised Officer

Dated 21 September 2020



ES2910

**THE CUMBRIA COUNTY COUNCIL (A689 (CARLISLE SOUTHERN LINK ROAD)
CLASSIFIED ROAD) (SIDE ROADS AND OTHER WORKS) ORDER 2020**

The Secretary of State for Transport hereby confirms the foregoing Order. The Secretary of State is satisfied -

- (a) as respects each highway the stopping up of which is authorised by the Order, that another reasonably convenient route is available or will be provided before that highway is stopped up, and
- (b) as respects each private means of access the stopping up of which is authorised by the Order, that other reasonably convenient means of access to the relevant premises are available or will be provided in pursuance of the Order before that private means of access is stopped up or that no access to the relevant premises is reasonably required.

This document has been signed by way of an electronic signature on 5th October 2021 at 17:30 at my home premises.



Signed by Authority
of the Secretary of State
5 October 2021

SIMON CONNICK
A senior civil servant in the
Department for Transport

THE CUMBRIA COUNTY COUNCIL (A689 (CARLISLE
SOUTHERN LINK ROAD) CLASSIFIED ROAD) (SIDE
ROADS AND OTHER WORKS) ORDER 2020

CLASSIFIED ROAD



ROUTE OF NEW HIGHWAY



HIGHWAY TO BE IMPROVED



HIGHWAY TO BE STOPPED UP



PRIVATE MEANS OF ACCESS TO BE
STOPPED UP



ROUTE OF NEW MEANS OF ACCESS



CONTENTS:
KEY PLAN, SITE PLAN

These site plans show the routes of new highways, the site of improvement,
stopping up and new accesses, but no widths or construction details.

KEY PLAN SCALE: 1:10,000
SITE PLAN SCALE: 1:2500

THE COMMON SEAL OF
CUMBRIA COUNTY COUNCIL
was hereunto affixed in the
presence of:-

.....
Authorised Officer

Dated *21 September*2020



ES291

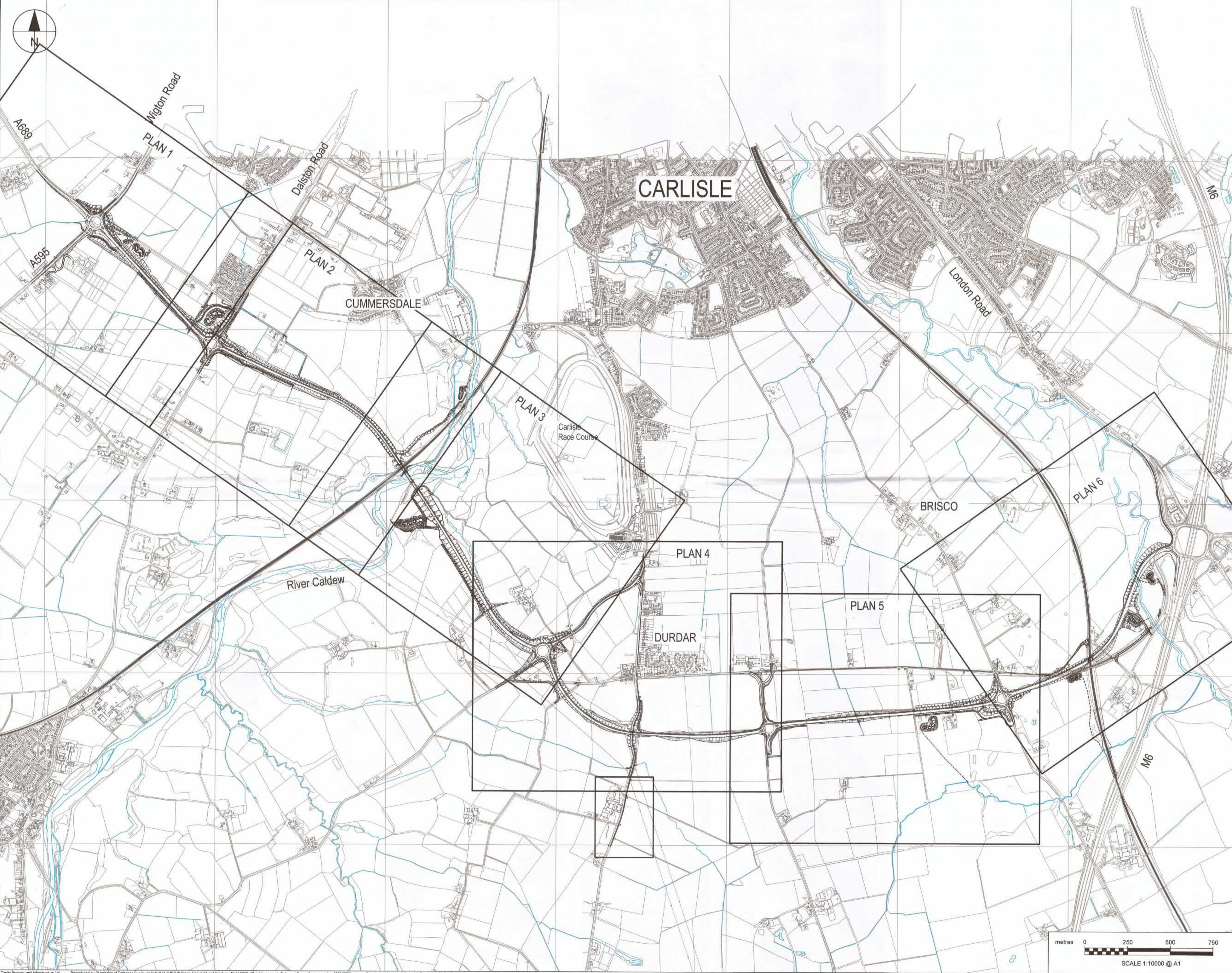

THE COMMON SEAL OF
CUMBRIA COUNTY COUNCIL
was hereunto affixed in the
presence of:-
Authorised Officer
Dated 21 September 2020

Rev	Drawn	Checked	App'd	Issued For Orders	Date
P01	JJA	WR	JG	ISSUED FOR ORDERS	2020-08-13

Purpose of Issue
S4 - Issued for Orders

Classification
Public

Client
Cumbria County Council

Project
Carlisle Southern Link Road

Drawing
MAP REFERRED TO IN
THE CUMBRIA COUNTY COUNCIL
(A689 (CARLISLE SOUTHERN LINK ROAD)
CLASSIFIED ROAD) (SIDE ROADS AND OTHER
WORKS) ORDER 2020
KEY PLAN

Scale at A1	Drawn	Checked	Approved
1:10000	JJA	WR	JG

Project No.	Date
CS/092903	2020-08-13

Drawing Identifier
Project - Originator - Zone - Level - File Type - Role - Number
CSLR-CAP-LSI-00-DR-Z-0100
Revision
P01

CAPITA
Property and Infrastructure
Englishgate Plaza, Botchergate, Carlisle, Cumbria, CA1 1RP
01228 673000
www.capitaproperty.co.uk
Capita Property and Infrastructure Ltd.

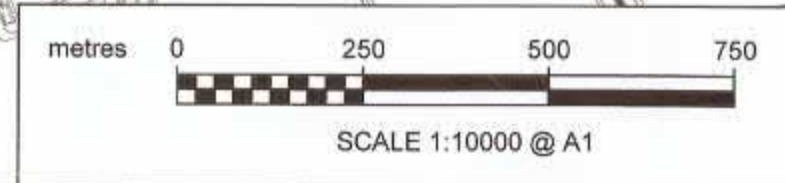

T:\202008\CARLISLE SOUTHERN LINK ROAD\CLASSIFIED ROAD\DRAWINGS\LSI-00-DR-Z-0100.DWG
 Printed by: John Adams Co. 13 August 2020 at 11:58
 © Capita Property and Infrastructure Ltd. Reproduced by Permission of Ordnance Survey on behalf of HM SO © Crown Copyright and Database Right 2019. All rights reserved. Ordnance Survey Licence number 100019556. Contains public sector information licensed under the Open Government Licence v3.0.

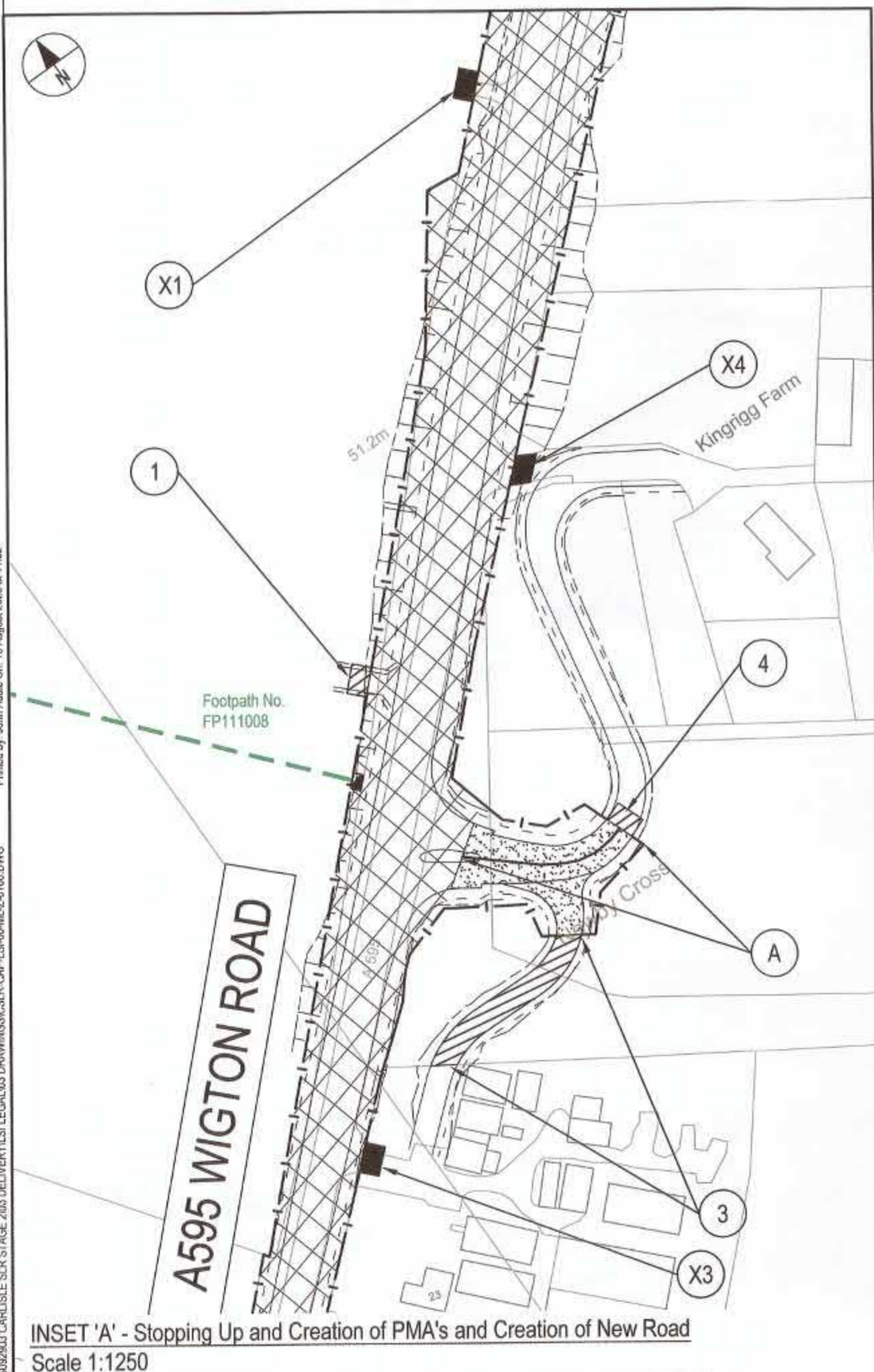
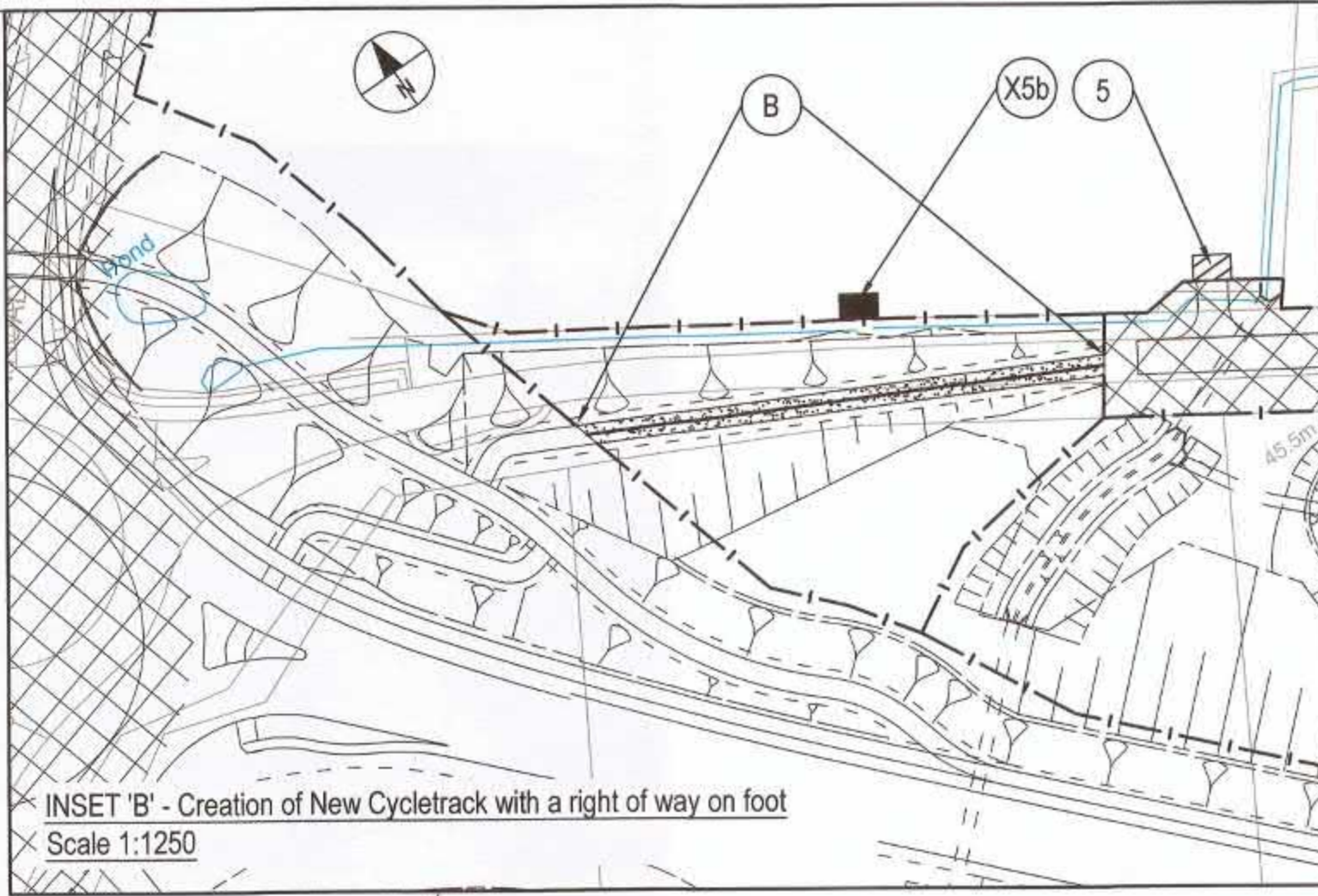
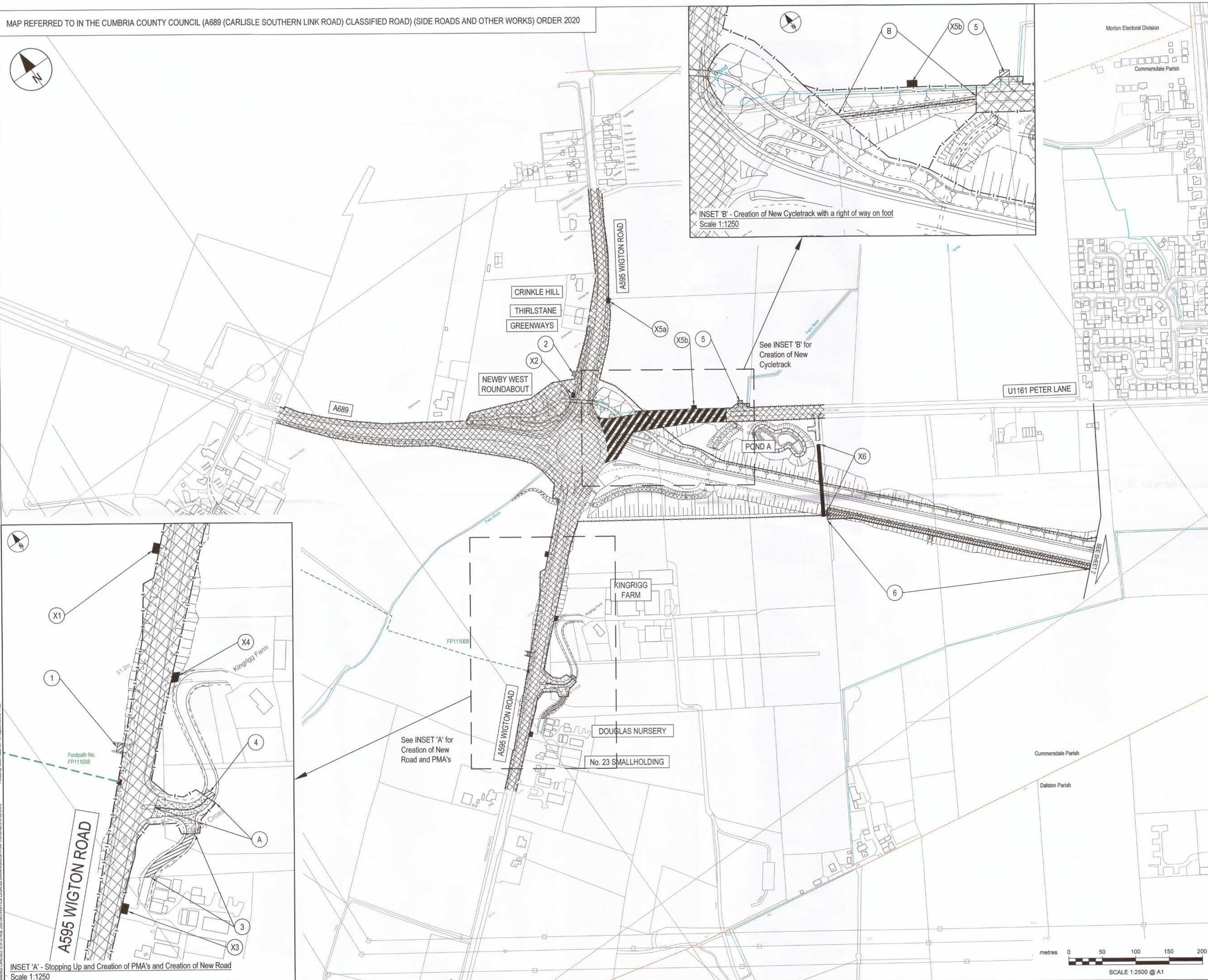

- KEY-**
- CLASSIFIED ROAD
 - ROUTE OF NEW HIGHWAY
 - HIGHWAY TO BE IMPROVED
 - HIGHWAY TO BE STOPPED UP
 - PRIVATE MEANS OF ACCESS TO BE STOPPED UP
 - ROUTE OF NEW MEANS OF ACCESS



THE COMMON SEAL OF CUMBRIA COUNTY COUNCIL was herewith affixed in the presence of:-

Authorised Officer
Dated 21 September 2020

Rev	Drawn	Checked	App'd	Description	Date
P01	JJA	WR	JG	ISSUED FOR ORDERS	2020-08-13

Purpose of Issue
S4 - Issued for Orders

Classification
Public

Client
Cumbria County Council

Project
Carlisle Southern Link Road

Drawing
MAP REFERRED TO IN THE CUMBRIA COUNTY COUNCIL (A689 (CARLISLE SOUTHERN LINK ROAD) CLASSIFIED ROAD) (SIDE ROADS AND OTHER WORKS) ORDER 2020
Site Plan 1 of 6

Scale at A1	Drawn	Checked	Approved
1:2500	JJA	WR	JG

Project No.	Date
CS/092903	2020-08-13

Drawing Identifier	Revision
Project - Originator - Zone - Level - File Type - Role - Number CSLR-CAP-LSI-00-DR-Z-0101	P01

CAPITA
Property and Infrastructure
Englishgate Plaza, Bolchergate, Carlisle, Cumbria, CA1 1RP
01228 673000
www.capitaproperty.co.uk
Capita Property and Infrastructure Ltd.

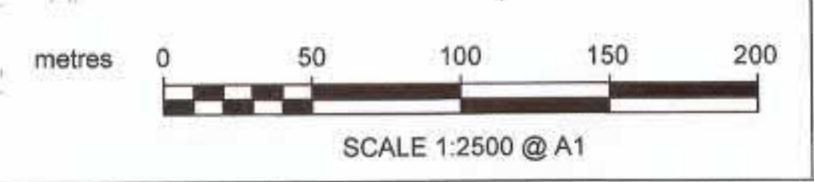

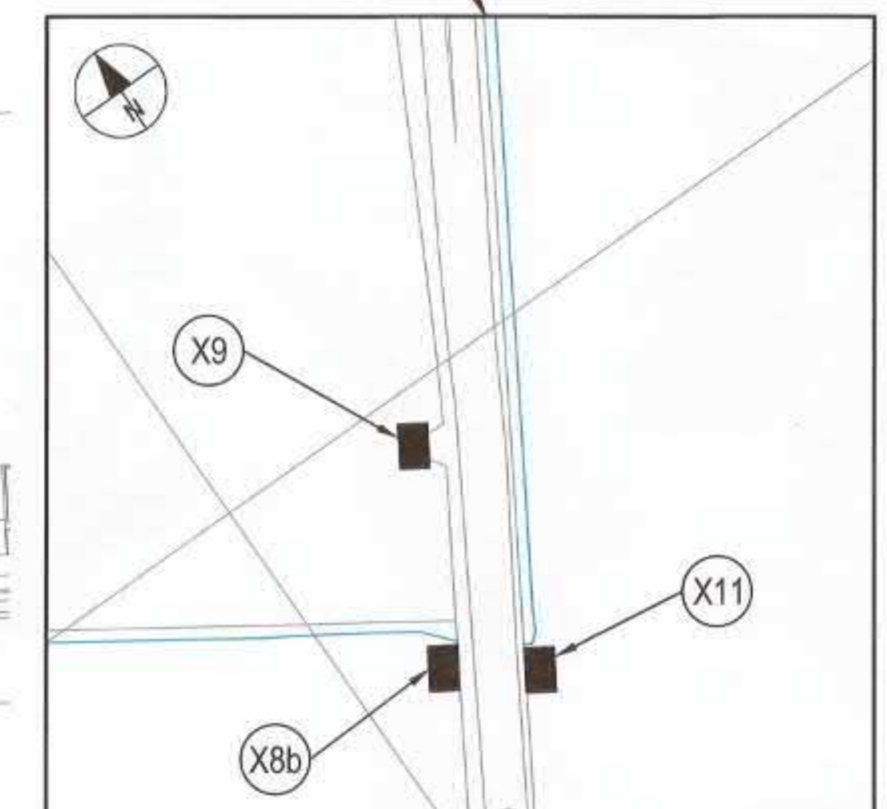
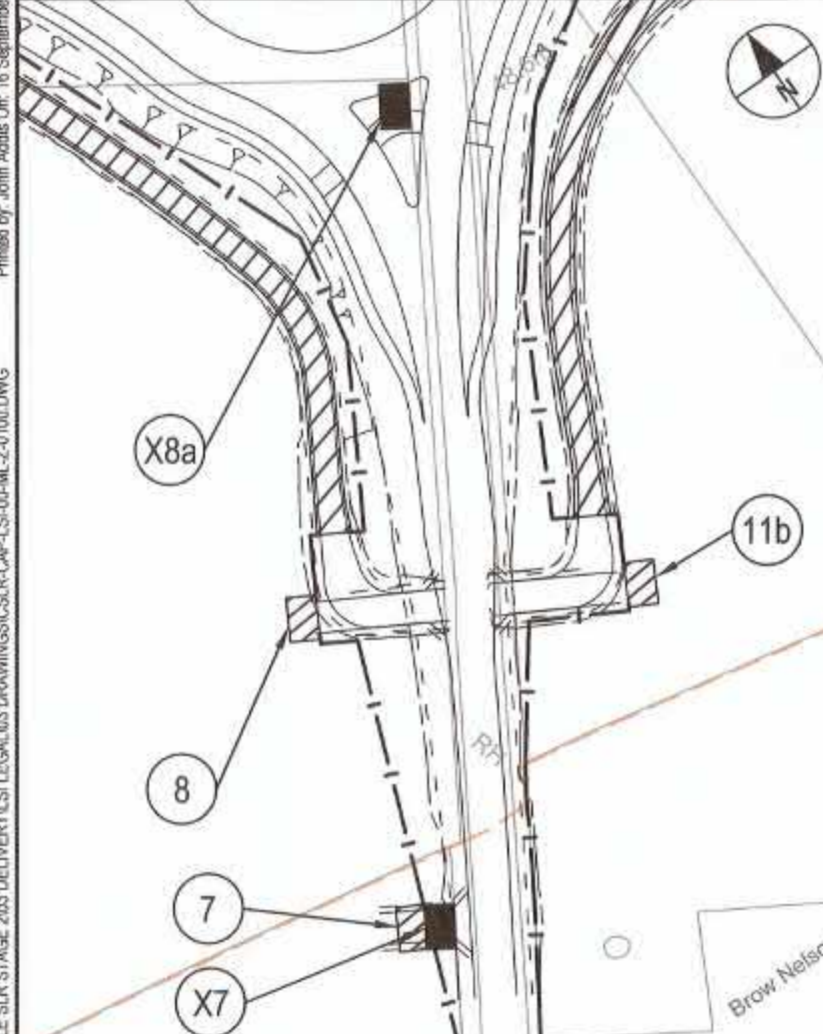
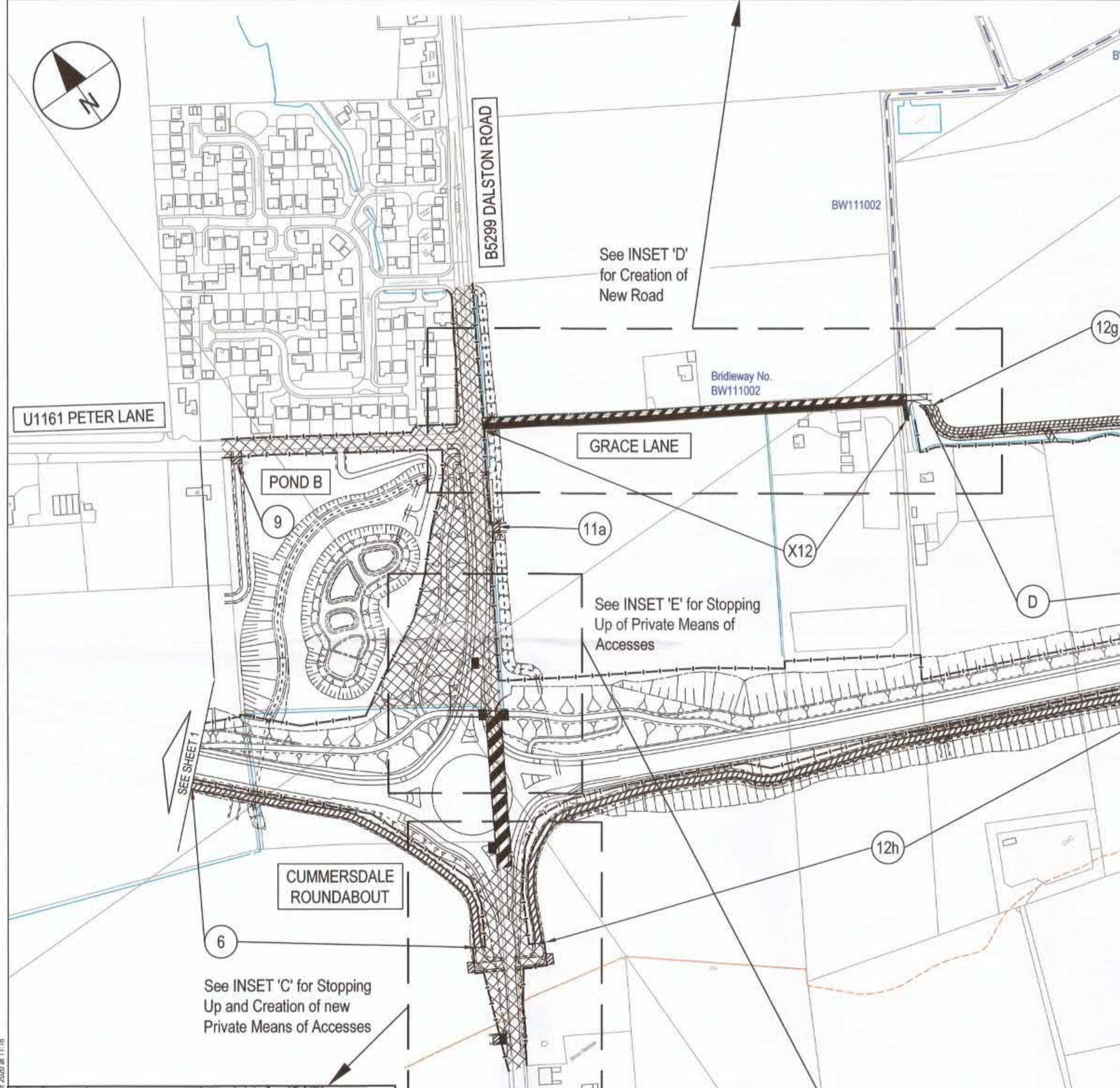
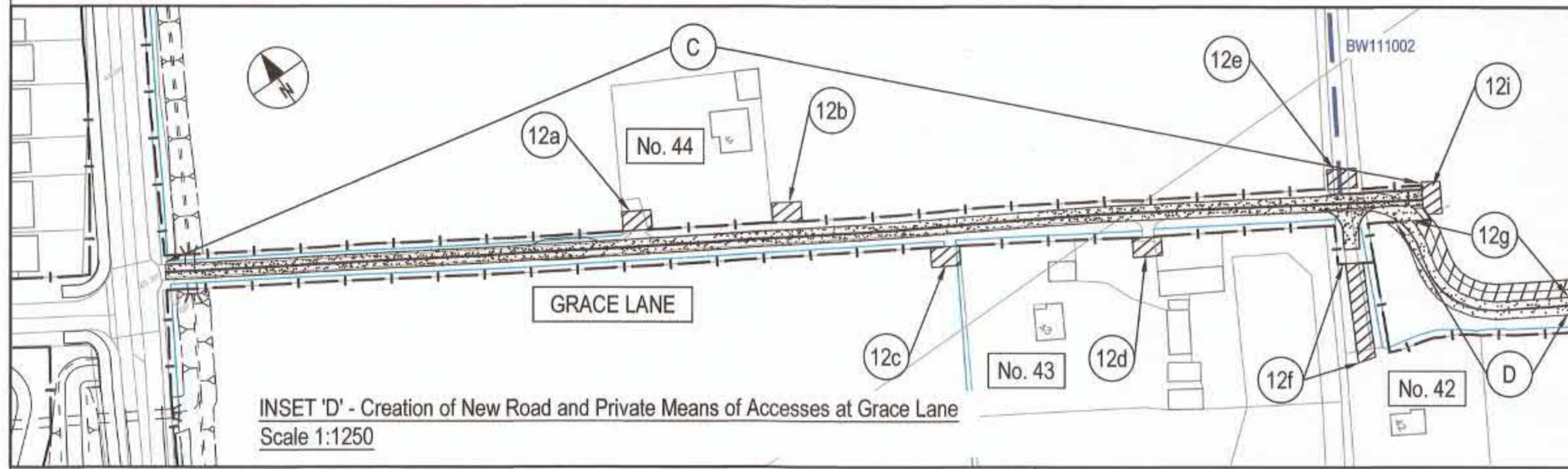

- KEY-**
- CLASSIFIED ROAD
 - ROUTE OF NEW HIGHWAY
 - HIGHWAY TO BE IMPROVED
 - HIGHWAY TO BE STOPPED UP
 - PRIVATE MEANS OF ACCESS TO BE STOPPED UP
 - ROUTE OF NEW MEANS OF ACCESS



ES294

THE COMMON SEAL OF CUMBRIA COUNTY COUNCIL was hereto affixed in the presence of-

Authorised Officer
Dated: 21 September 2020

Rev	Drawn	Checked	App'd	Description	Date
P02	JJA	WR	JG	LENGTH OF STOPPING UP OF FOOTPATH FP11005 REDUCED.	2020-09-15
P01	JJA	WR	JG	STOPPING UP OF FOOTPATH FP114053 REMOVED. ISSUED FOR ORDERS	2020-08-13

Purpose of Issue
S4 - Issued for Orders

Classification
Public

Client
Cumbria County Council

Project
Carlisle Southern Link Road

Drawing
MAP REFERRED TO IN THE CUMBRIA COUNTY COUNCIL (A689 (CARLISLE SOUTHERN LINK ROAD) CLASSIFIED ROAD) (SIDE ROADS AND OTHER WORKS) ORDER 2020
Site Plan 2 of 6

Scale at A1	Drawn	Checked	Approved
1:2500	JJA	WR	JG

Project No. CS/092903 Date 2020-08-13

Drawing Identifier
Project - Originator - Zone - Level - File Type - Role - Number
CSLR-CAP-LSI-00-DR-Z-0102 P02

CAPITA
Property and Infrastructure
Englishgate Plaza, Botchergate, Carlisle, Cumbria, CA1 1RP
01228 673000
www.capita-property.co.uk
Capita Property and Infrastructure Ltd.

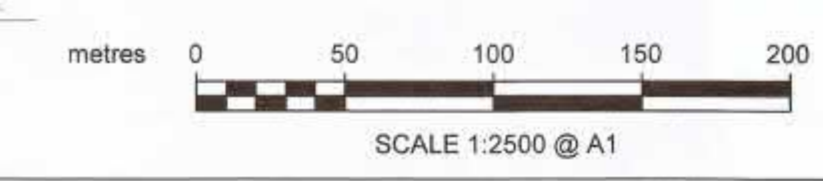



- KEY-**
- CLASSIFIED ROAD
 - ROUTE OF NEW HIGHWAY
 - HIGHWAY TO BE IMPROVED
 - HIGHWAY TO BE STOPPED UP
 - PRIVATE MEANS OF ACCESS TO BE STOPPED UP
 - ROUTE OF NEW MEANS OF ACCESS



THE COMMON SEAL OF CUMBRIA COUNTY COUNCIL was hereto affixed in the presence of:-

Authorised Officer
 Dated 21 September 2020

Rev	Drawn	Checked	Approved	Description	Date
P01	JJA	WR	JG	ISSUED FOR ORDERS	2020-08-13

Purpose of Issue
S4 - Issued for Orders

Classification
Public

Client
Cumbria County Council

Project
Carlisle Southern Link Road

Drawing
 MAP REFERRED TO IN THE CUMBRIA COUNTY COUNCIL (A689 (CARLISLE SOUTHERN LINK ROAD) CLASSIFIED ROAD) (SIDE ROADS AND OTHER WORKS) ORDER 2020
 Site Plan 3 of 6

Scale at A1	Drawn	Checked	Approved
1:2500	JJA	WR	JG

Project No.	Date
CS/092903	2020-08-13

Drawing Identifier	Revision
Project - Originator - Zone - Level - File Type - Role - Number CSLR-CAP-LSI-00-DR-Z-0103	P01

CAPITA
 Property and Infrastructure
 Englishgate Plaza, Botchergate, Carlisle, Cumbria, CA1 1RP
 01228 673000
 www.capitaproperty.co.uk
 Capita Property and Infrastructure Ltd.

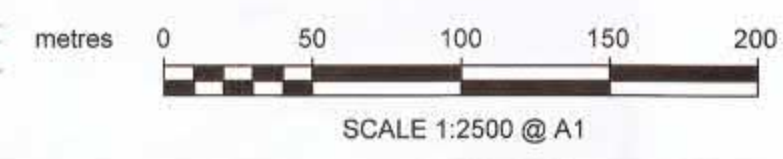

Printed by John White on 13 August 2020 at 11:40
 C:\WORKING\CARLISLE_SLR_PFAZE_2ND_DELIVERY\LSI_LEGAL\DRAWINGS\CSLR-CAP-LSI-00-DR-Z-0103.dwg
 © Capita Property and Infrastructure Ltd. Reproduced by Permission of Ordnance Survey on behalf of HMSO © Crown Copyright and Database Right 2019. All rights reserved. Ordnance Survey Licence number: 100019595. Contains public sector information licensed under the Open Government Licence v3.0.

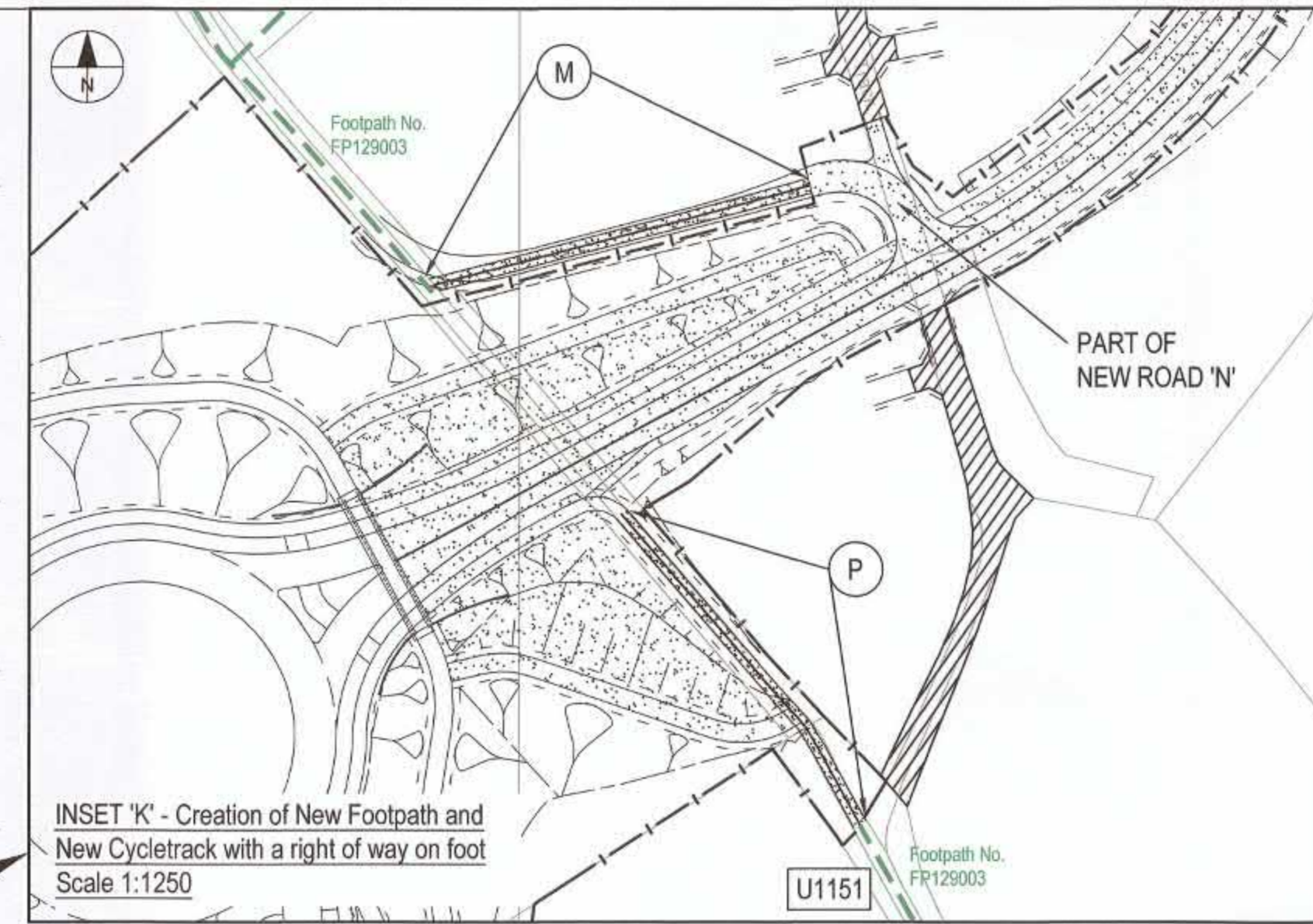
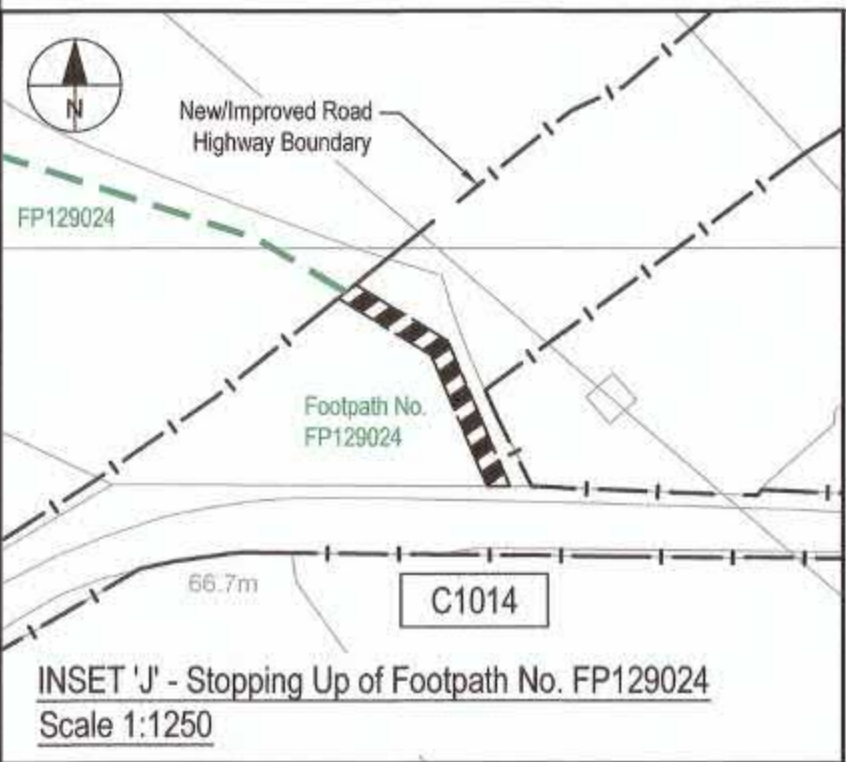

- KEY-**
- CLASSIFIED ROAD
 - ROUTE OF NEW HIGHWAY
 - HIGHWAY TO BE IMPROVED
 - HIGHWAY TO BE STOPPED UP
 - PRIVATE MEANS OF ACCESS TO BE STOPPED UP
 - ROUTE OF NEW MEANS OF ACCESS



THE COMMON SEAL OF CUMBRIA COUNTY COUNCIL was herewith affixed in the presence of-

Authorised Officer
Dated 21 September 2020

P01	JJA	WR	JG	ISSUED FOR ORDERS	2020-08-13
Rev	Drawn	Checked	Appd	Description	Date

Purpose of Issue
S4 - Issued for Orders

Classification
Public

Client
Cumbria County Council

Project
Carlisle Southern Link Road

Drawing
MAP REFERRED TO IN THE CUMBRIA COUNTY COUNCIL (A689 (CARLISLE SOUTHERN LINK ROAD) CLASSIFIED ROAD) (SIDE ROADS AND OTHER WORKS) ORDER 2020
Site Plan 4 of 6

Scale at A1	Drawn	Checked	Approved
1:2500	JJA	WR	JG
Project No.	Date		
CS/092903	2020-08-13		

Drawing Identifier
Project - Originator - Zone - Level - File Type - Role - Number
CSLR-CAP-LSI-00-DR-Z-0104

CAPITA
Property and Infrastructure
Englishgate Plaza, Botchergate, Carlisle, Cumbria, CA1 1RP
01228 673000
www.capitaproperty.co.uk
Capita Property and Infrastructure Ltd.

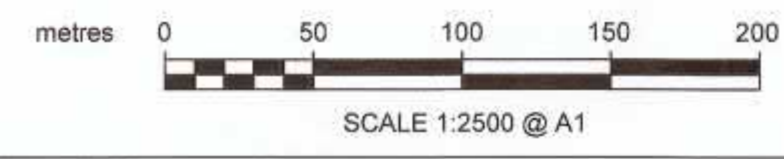
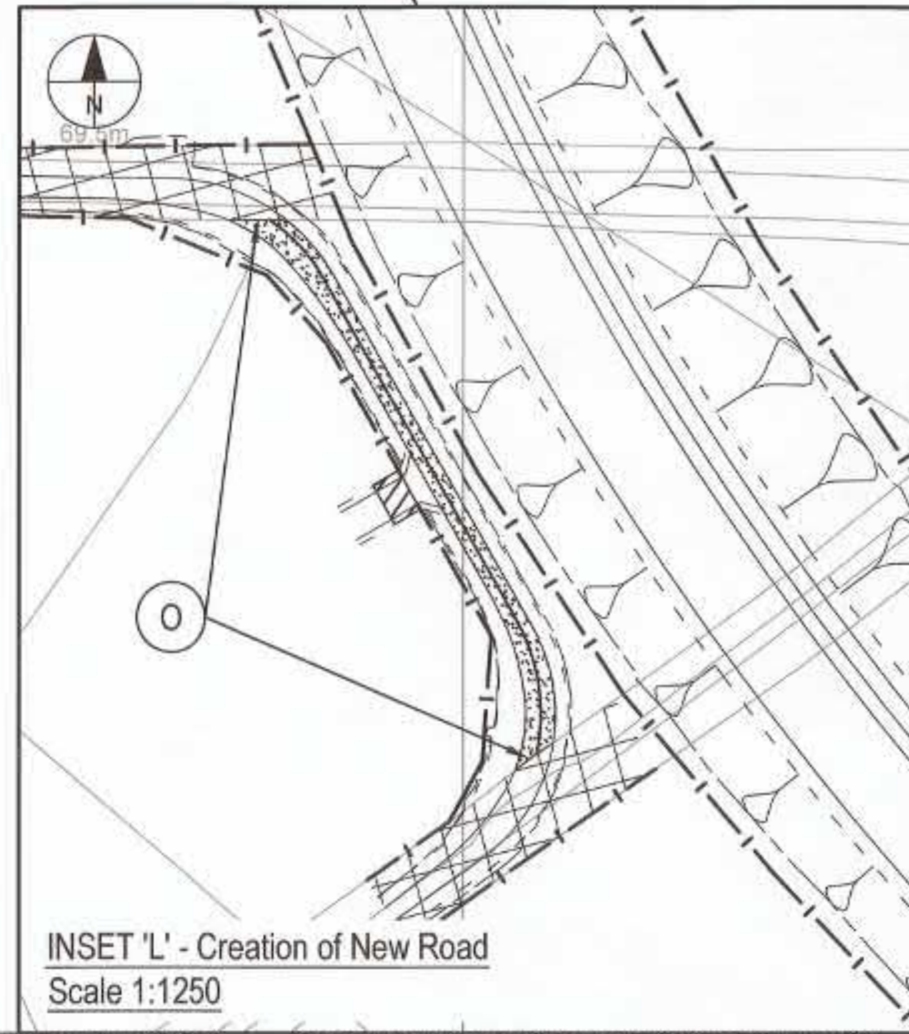
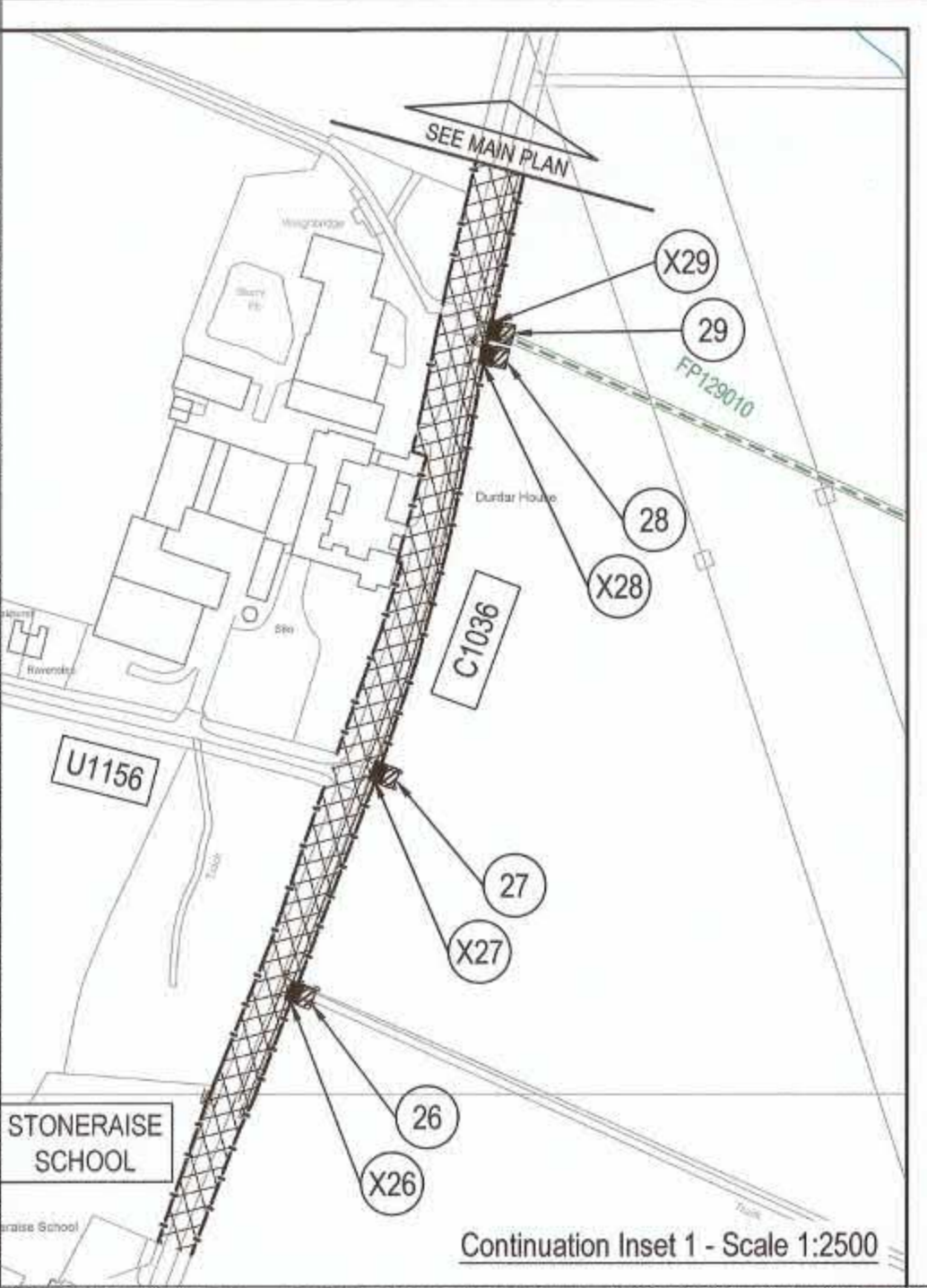
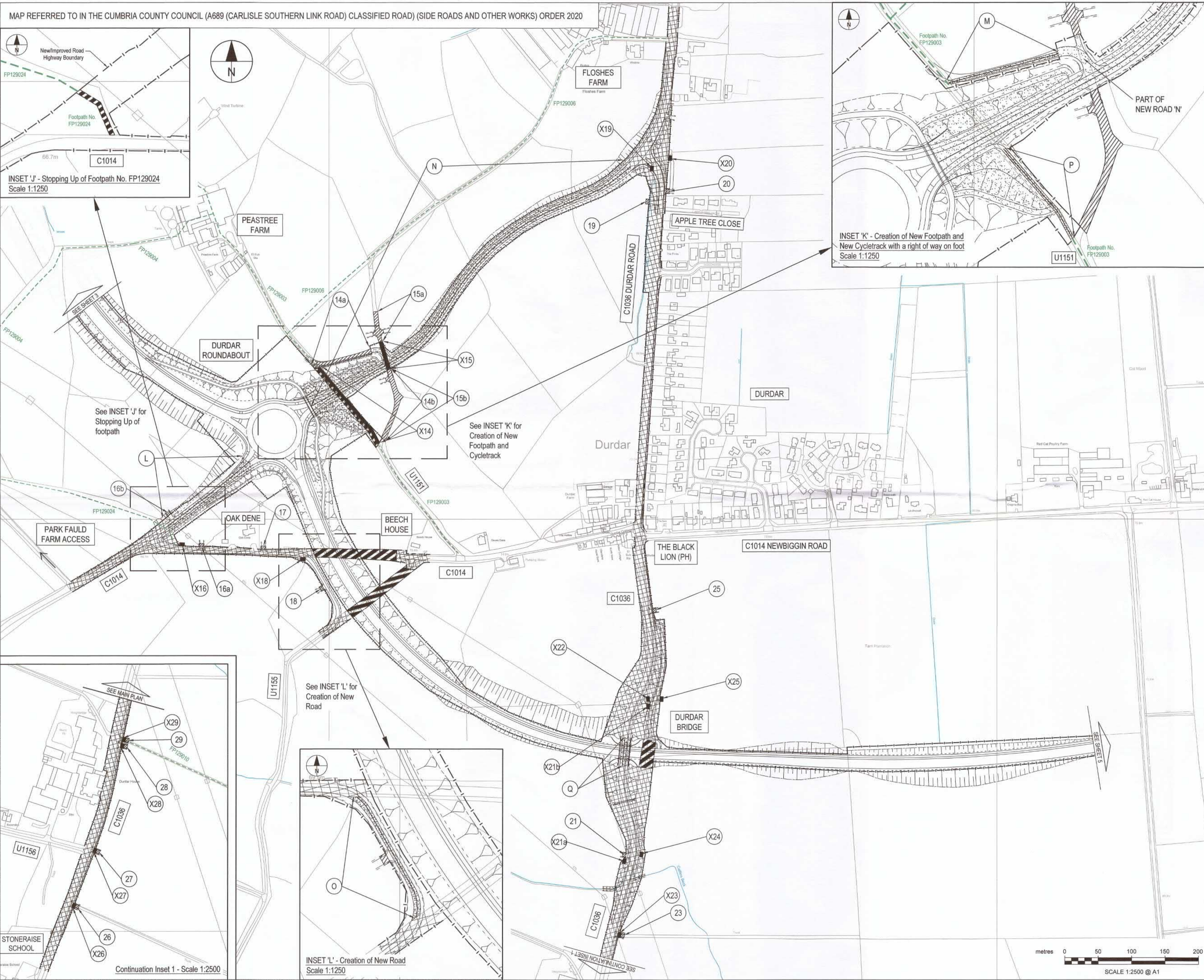

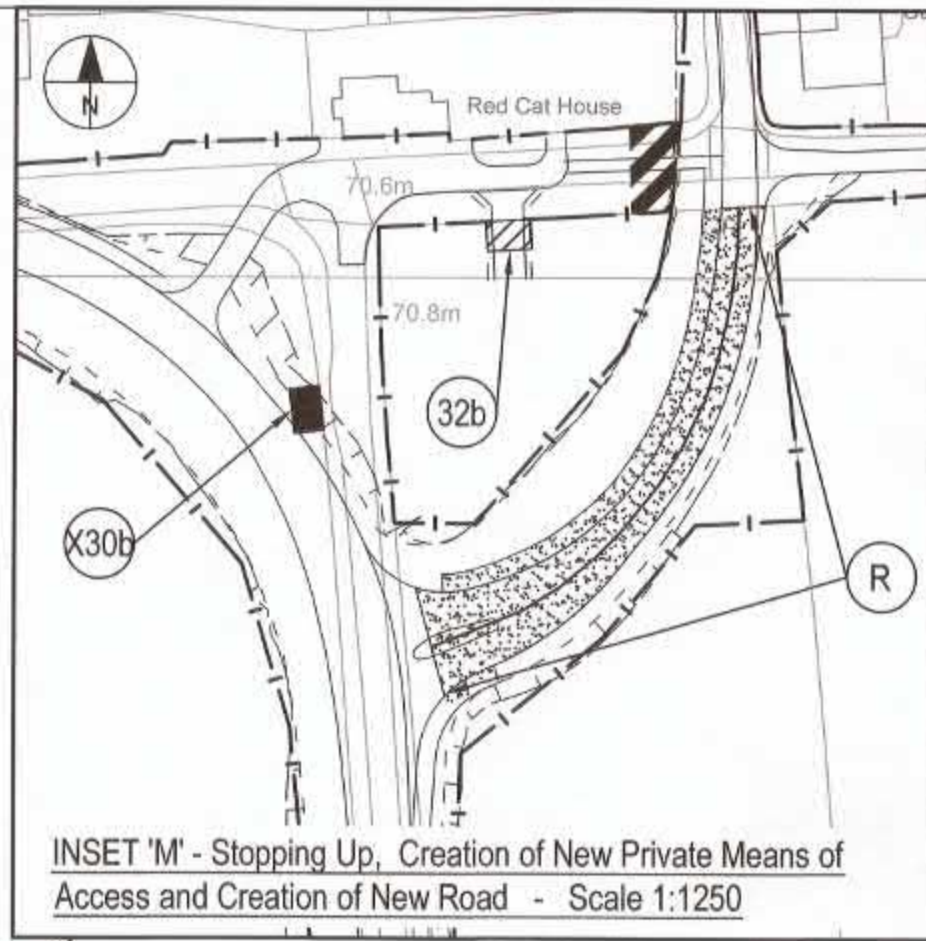

INSET 'M' - Stopping Up, Creation of New Private Means of Access and Creation of New Road - Scale 1:1250

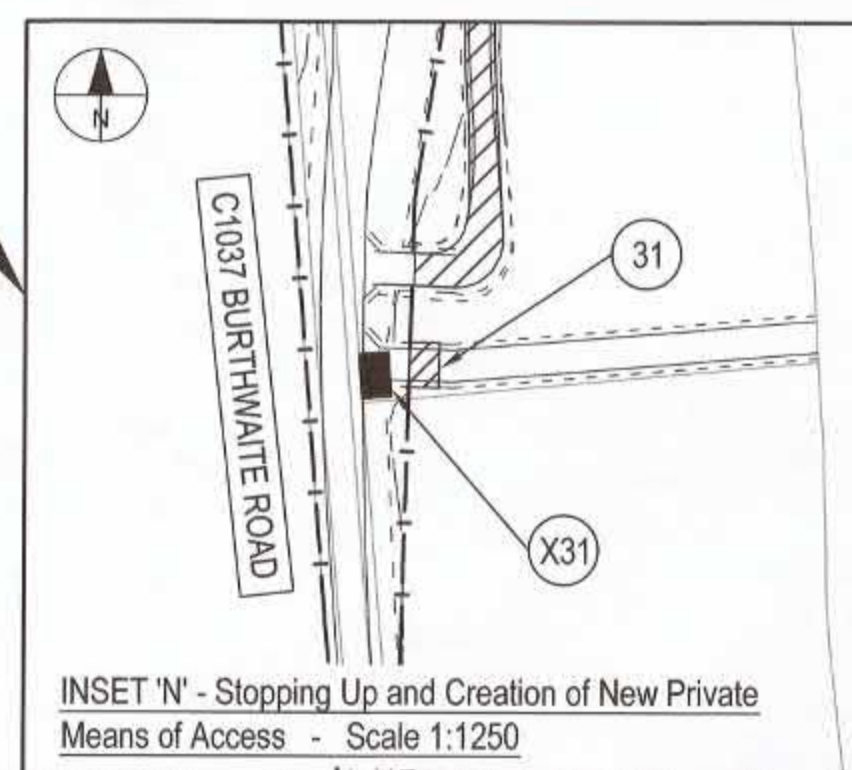

INSET 'N' - Stopping Up and Creation of New Private Means of Access - Scale 1:1250

- KEY-**
- CLASSIFIED ROAD
 - ROUTE OF NEW HIGHWAY
 - HIGHWAY TO BE IMPROVED
 - HIGHWAY TO BE STOPPED UP
 - PRIVATE MEANS OF ACCESS TO BE STOPPED UP
 - ROUTE OF NEW MEANS OF ACCESS



ES297

THE COMMON SEAL OF CUMBRIA COUNTY COUNCIL was hereunto affixed in the presence of-

Authorised Officer

Dated 21 September 2020

Rev	Drawn	Checked	App'd	Description	Date
P01	JJA	WR	JG	ISSUED FOR ORDERS	2020-08-13

Purpose of Issue
S4 - Issued for Orders

Classification
Public

Client
Cumbria County Council

Project
Carlisle Southern Link Road

Drawing
MAP REFERRED TO IN THE CUMBRIA COUNTY COUNCIL (A689 (CARLISLE SOUTHERN LINK ROAD) CLASSIFIED ROAD) (SIDE ROADS AND OTHER WORKS) ORDER 2020
Site Plan 5 of 6

Scale at A1	Drawn	Checked	Approved
1:2500	JJA	WR	JG

Project No.	Date
CS/092903	2020-08-13

Drawing Identifier	Revision
Project - Originator - Zone - Level - File Type - Role - Number CSLR-CAP-LSI-00-DR-Z-0105	P01

CAPITA
Property and Infrastructure
Englishgate Plaza, Botchergate, Carlisle, Cumbria, CA1 1RP
01228 673000
www.capitaproperty.co.uk
Capita Property and Infrastructure Ltd.

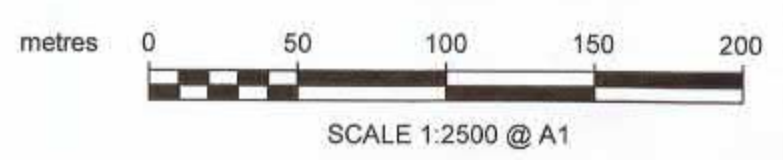

T:\2020\03\CARLISLE SOUTHERN LINK ROAD\2020\DRAWINGS\LSI-CAP-LSI-00-DR-Z-0105.DWG
 Printed by: John Adams on: 13 August 2020 at 11:46
 Contains public sector information licensed under the Open Government Licence v3.0

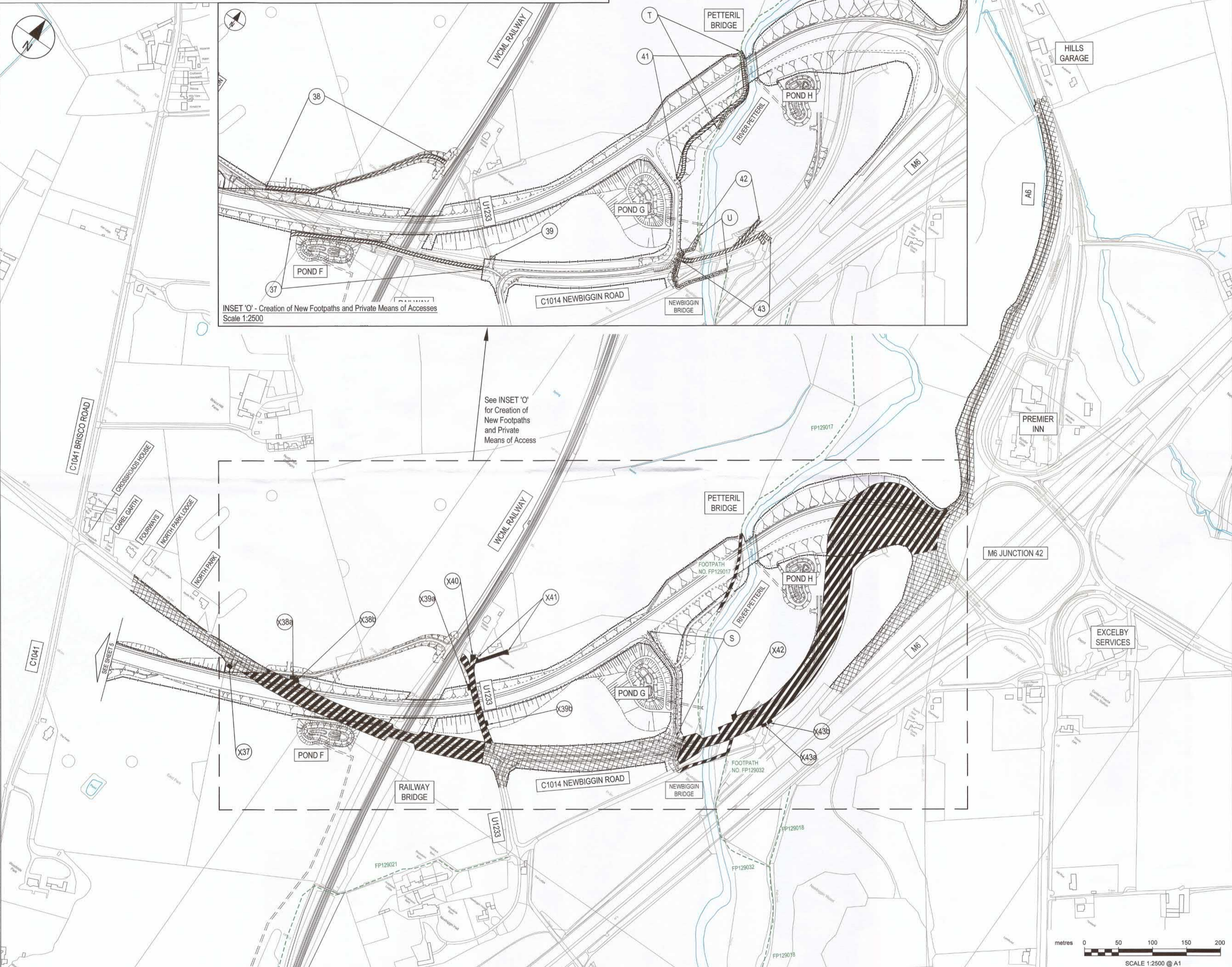

INSET 'O' - Creation of New Footpaths and Private Means of Accesses
Scale 1:2500

See INSET 'O'
for Creation of
New Footpaths
and Private
Means of Access

- KEY-**
- CLASSIFIED ROAD
 - ROUTE OF NEW HIGHWAY
 - HIGHWAY TO BE IMPROVED
 - HIGHWAY TO BE STOPPED UP
 - PRIVATE MEANS OF ACCESS TO BE STOPPED UP
 - ROUTE OF NEW MEANS OF ACCESS



THE COMMON SEAL OF
CUMBRIA COUNTY COUNCIL
was herewith affixed in the
presence of:-
Authorised Officer
Dated 23 September 2020

Rev	Drawn	Checked	Approved	Description	Date
	JJA	WR	JG	ISSUED FOR ORDERS	2020-08-13

Purpose of Issue
S4 - Issued for Orders

Classification
Public

Client
Cumbria County Council

Project
Carlisle Southern Link Road

Drawing
MAP REFERRED TO IN
THE CUMBRIA COUNTY COUNCIL
(A689 (CARLISLE SOUTHERN LINK ROAD)
CLASSIFIED ROAD) (SIDE ROADS AND OTHER
WORKS) ORDER 2020
Site Plan 6 of 6

Scale at A1	Drawn	Checked	Approved
1:2500	JJA	WR	JG
Project No.	Date		
CS/092903	2020-08-13		

Drawing Identifier
Project - Originator - Zone - Level - File Type - Role - Number
CSLR-CAP-LSI-00-DR-Z-0106 P01

CAPITA
Property and Infrastructure
Englishgate Plaza, Bolton, Greater Manchester, M40 1RP
01228 673000
www.capitaproperty.co.uk
Capita Property and Infrastructure Ltd.

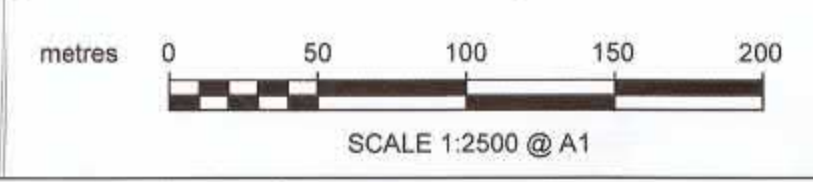

© Capita Property and Infrastructure Ltd. Reproduced by Permission of Ordnance Survey on behalf of HMGO © Crown Copyright and Database Right 2015. All rights reserved. Ordnance Survey licence number 100019556. Contains public sector information licensed under the Open Government Licence v3.0.